

Stracam Corner, Belfast (north-west side) – from a point 87 metres south-east then 76 metres north-east of the, The Straight outside No.24. for a distance of 3 metres in a north-easterly direction.

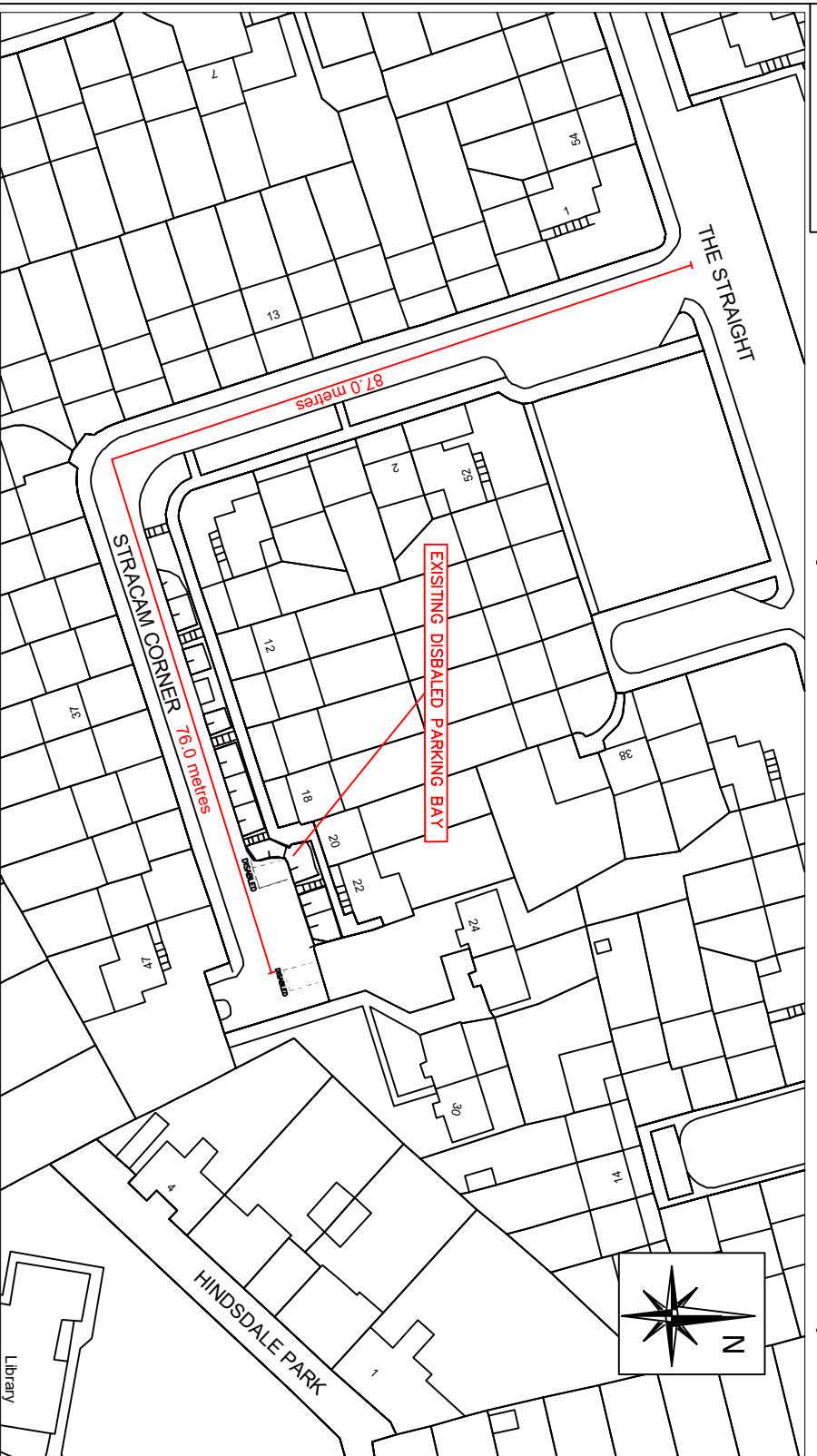

1:1000

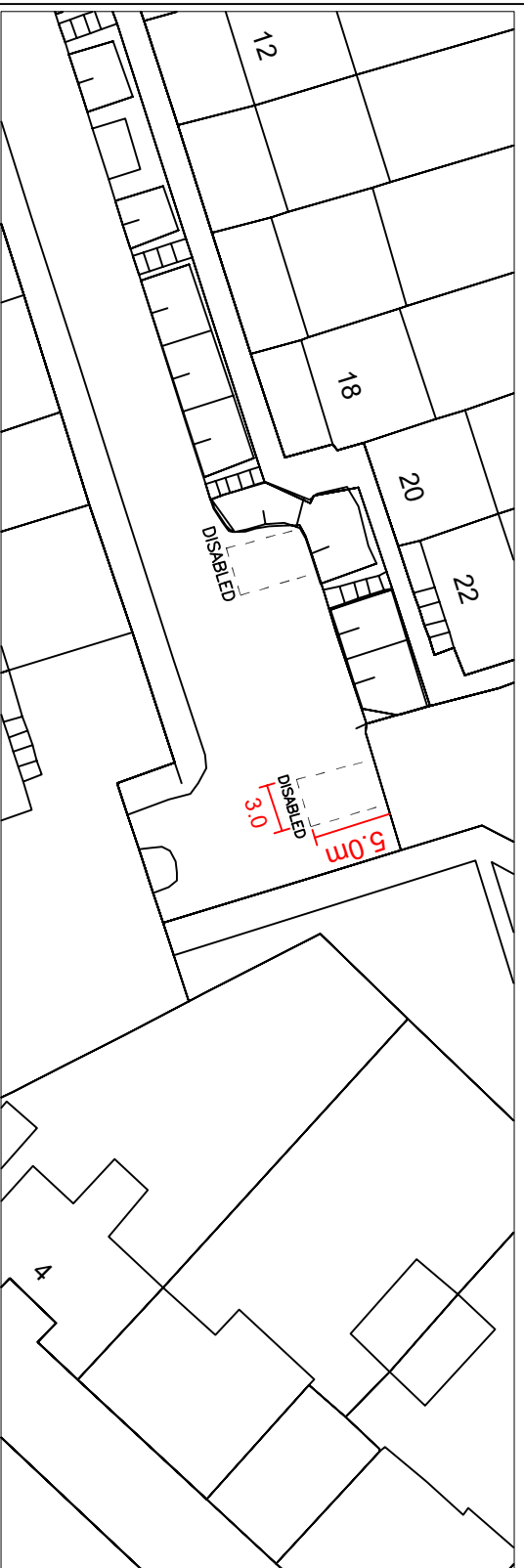

1:500

NO.	REVISION	DATE

Based upon the Ordnance Survey of Northern Ireland 1:1000 Scale Map with the Permission of the Director and Chief Executive  
 © Crown Copyright  
 Unauthorised reproduction infringes Crown Copyright and may lead to prosecution or civil proceedings

Project  
 26 STRACAM CORNER  
 BELFAST

Title  
 PROPOSED ACCESSIBLE/  
 DISABLED PARKING BAY

FILE NO.	DESIGNED	AO'H	date	JUL '22

Dwg. No.  
 TM2/BEL/JUL/22/25/A

Scales  
 AS SHOWN

Eastern Division  
 Annex 7  
 Castle Buildings  
 Stormont Estate  
 Belfast  
 BT4 3SQ

Telephone: 0300 200 7893  
 Textphone: 028 90540022



www.infrastructure-ni.gov.uk

