

SR 2017 No. 182 Item 2428. Carncaver Road, Belfast (north-west side) – from a point 116 metres south-west of its junction with Espie Way, for a distance of 5.5 metres in a south-westerly direction.

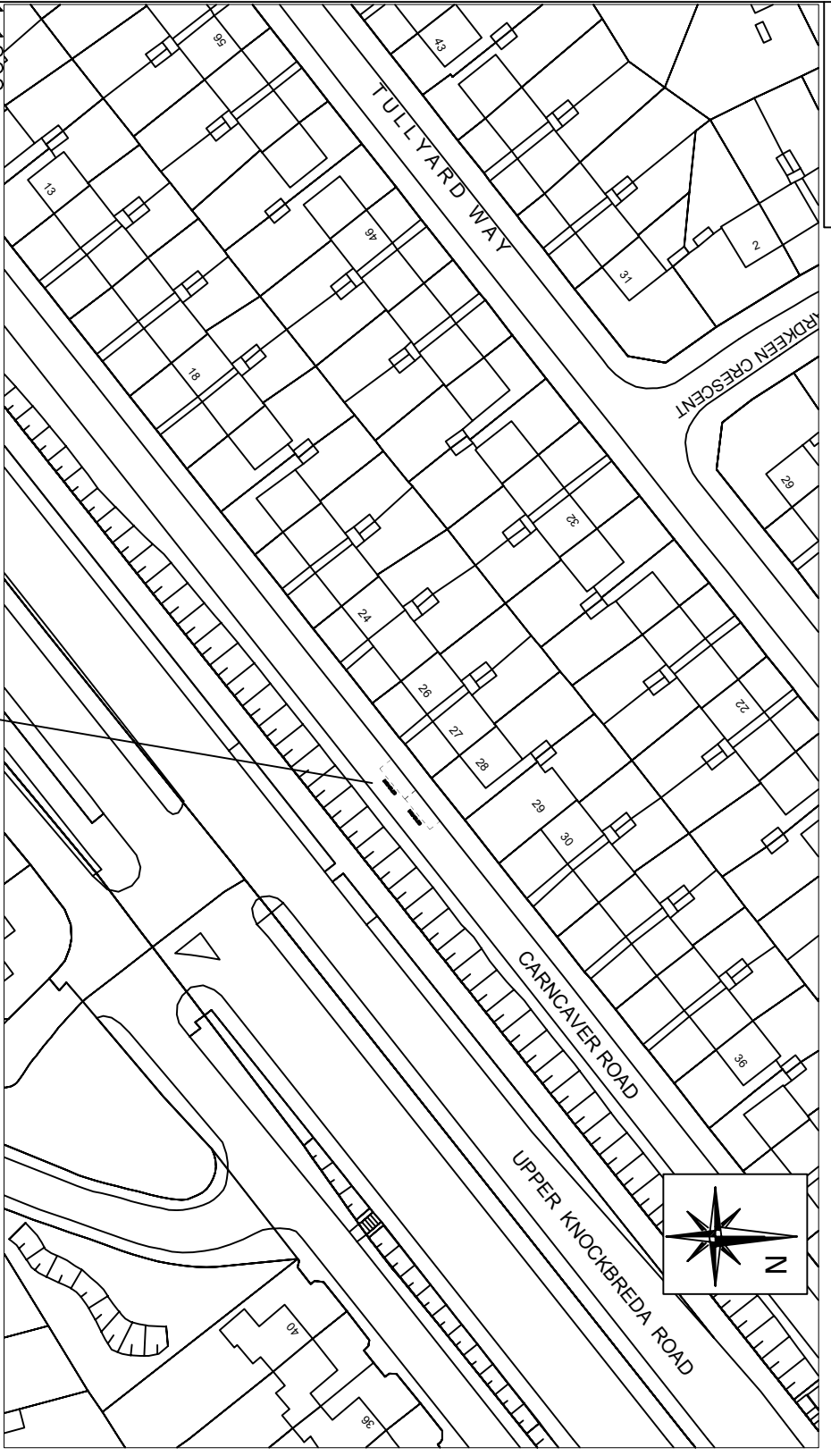

1:1000

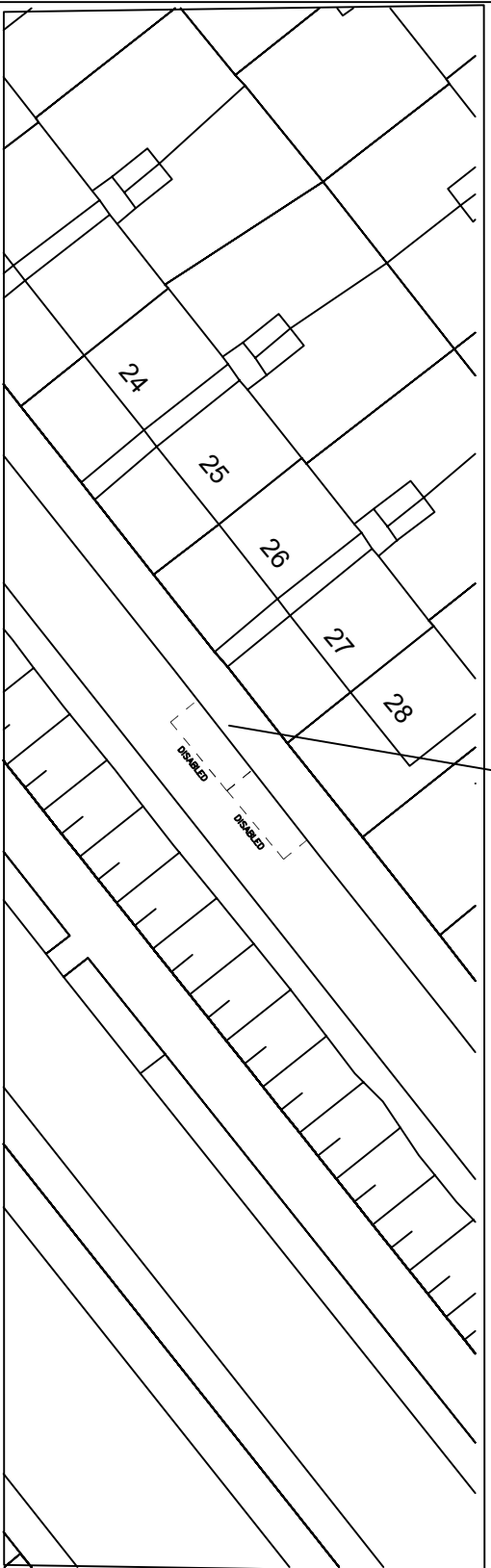

1:500

| NO. | REVISION | DATE |
|-----|----------|------|
| | | |

Based upon the Ordnance Survey of Northern Ireland 1:1000 Scale Map with the Permission of the Director and Chief Executive
 © Crown Copyright
 Unauthorised reproduction infringes Crown Copyright and may lead to prosecution or civil proceedings

Project: **REMOVAL OF AN ACCESSIBLE / DISABLED PARKING BAY**

Title: **27 CARNCAVER ROAD BELFAST**

| FILE NO. | DESIGNED | AO'H | date |
|----------|----------|------|--------|
| DRAWN | CHECKED | | MAY'24 |
| TRACED | APPROVED | | date |

| Dwg. No. | Revision |
|---------------------|----------|
| TM2/BEL/MAY/24/27/A | |

Scales: AS SHOWN

Eastern Division
 Annex 7
 Castle Buildings
 Stormont Estate
 Belfast
 BT4 3SQ

Telephone: 0300 200 7893
 Textphone: 028 90540022